

InRouter 6X5 Series

Smart 4 Ethernet LAN/ Wi-Fi /Serial to Ethernet WAN/HSPA+/UMTS



Compact Design: 4 Ethernet LAN switch ports, RS232/485 (DB9), Wi-Fi (2.4GHz 802.11b/g/n), 3G/UMTS or Ethernet WAN connection

Power supply: 9-26V DC Power Terminal

High security: Advanced VPN (IPSec/SSL/GRE/L2TP/PPTP)

Centralized management platform: InHand Device Manager Cloud

Reliable for almost all industrial conditions



Overview

InRouter6X5 series are compact designed industrial cellular routers which can help users to quickly access to high-speed Internet and support secure and reliable data transmission. The products combine together with the functions of unmanaged switch, serial server, 3G Router, IP modem, Advanced VPN client and even WIFI and provide with high cost-effective solution for applications in industrial automation and control, fleet monitoring, video surveillance, advertising media, and outlets networking. You can even configure it easily through the browser on your IOS or Android terminals without connection to the router by cable.

Besides flexibility, InRouter6X5 series can provide reliable data link. For example, the multi-level linkage detection ensures linkage stability especially for applications in unattended areas. The outstanding performance under wide temperature and harsh electromagnetic field enables the capability to work under harsh conditions.

Specification

Interfaces

WAN Interfaces

Ethernet WAN: Static IP/PPPoE/DHCP Client
 Cellular WAN: HSPA+: 21Mbps (DL)/5.76Mbps (UL)
 GSM/GPRS/EDGE: 850/900/1800/1900 MHz
 UMTS /HSPA/HSPA+: 850/900/1900/2100 MHz

LAN Interfaces

Auto Adaption: 4 10M/100M Ethernet ports, auto-adaptive MDI/MDI-X auto crossover
 Isolation Protection: 1.5KV isolation protection

Power supply

9-26V DC 5.08mm 2pin Terminal power supply

Wi-Fi (Optional)

Wireless: 150Mbps 802.11b/g/n Work mode: AP/Client
 Authentication: open, WEP, WPA/WPA-2(Personal), PA/WPA-2(Enterprise)

Serial ports

Number: 1 RS232/RS485 DB9
 Protocol: Modbus RTU, Transparent TCP, Virtual COM

Environmental

Operating temperature: -20°C~70°C

Storage temperature: -40°C ~85°C

Humidity: 5%~95%, no-condensing

Protection grade: IP40

EMC

ESD: EN61000-4-2 Surge: EN61000-4-5
 EFT: EN61000-4-4 RF: EN61000-4-3
 RC: EN61000-4-6 Oscillatory Wave Immunity: EN61000-4-12
 Variation Magnetic Field Immunity: EN61000-4-8

Safety

Anti-shock: IEC60068-2-27
 Anti-drop: IEC60068-2-32
 Anti-vibration: IEC60068-2-6

Reliable Network Link

Built-in hardware watchdog, self-recovery
 PPP link detection disaster self-recovery
 Professional upgrades mechanism, assure upgrade safety

Firewall security service

State Packet Inspection, anti-DoS attacks, Filter multicast
Filter ping, Access control list

Configuration

DB9 Console port, Telnet, and Web configuration

Upgrade

Remote upgrade and web upgrade, utilizing redundant backup mechanism for worry-free upgrade

Network Function

Network Address Translation (NAT) and Port Address Translation (PAT)
Deny illegitimate host access

TCP/IP Protocols

ICMP, IP, TCP, UDP, DHCP, PPP, ARP, Telnet, DNS, SSH, VRRP, HTTP, HTTPS,
VPN (IPSec/SSL/PPTP/L2TP/GRE)

Installation

Optional Wall mounting kits or DIN mounting Kits

Warranty

Warranty Period: 1 year, for more period please contact InHand sales

Dimensions (Unit: mm)

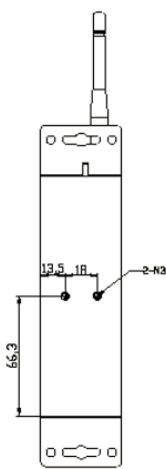

Back View

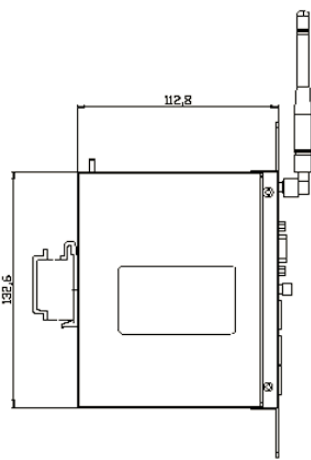

Side View

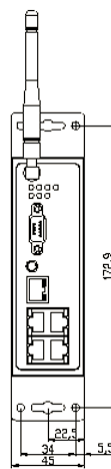

Front View

DB9 RS232 /RS485 Port

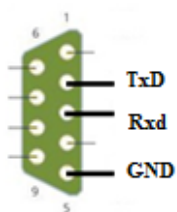

RS232

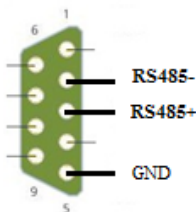

RS485

Device Manager Cloud

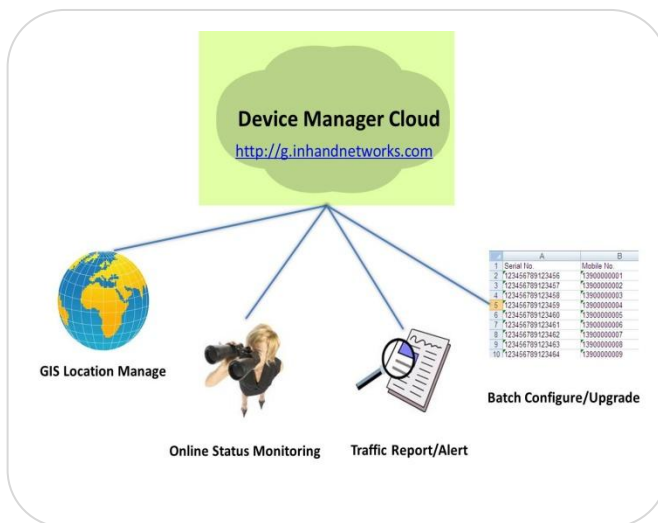

Order Information

Model	IR6x5
Part Number	IR6<X>5-<N>-<W>-<P>-<S>
X (Option VPN)	0: standard router; 9: VPN, support IPSec/SSL/PPTP/L2TP/GRE
N (Network)	UE00: No wireless module WH01: UMTS/HSDPA (850/900/1900/2100 MHz) VZ16:CDMA2000 EVDO\1X(800MHz/1900MHz/2100MHz) VZ01: EVDO(800MHz/1900MHz. for China/India only) PH01:HSPA+ (850/900/1900/2100 MHz)
W (Wi-Fi)	<NA>: No Wi-Fi function AP: Wi-Fi AP mode STA: Wi-Fi client mode
S (Serial port)	<NA> : RS232 485 : RS485
Example	IR6 9 5 WH01-AP : UMTS/HSDPA, Support VPN(IPSec/PPTP/L2TP/GRE) ,Wi-Fi AP, RS232 serial port

Notice: R695WH01-AP/STA does not support OpenVPN.



Connecting Devices, Enabling Services

info@inhandnetworks.com